

Troubleshooting

The units red LED does not flash when the batteries are installed

Ensure the batteries are connected correctly according to the diagram in the battery compartment.

The red light keeps flashing

This is the 'low battery' indicator. Replace the unit's batteries.

Factory reset

If you forget your PIN or the system malfunctions, you can press the reset button (located behind battery cover) to erase all memory. Please ensure the device is powered and system is in Disarm mode. After reset you will need to set-up your PIN again and pair with other devices (if required).

Battery precautions

When using this product follow these precautions at all times;

- Use only the appropriate size batteries
- Be sure to follow the correct polarity when installing the batteries as indicated in the battery compartment. Incorrect polarity may cause damage to the unit
- Do not mix old and new batteries
- If the alarm is not used for long periods of time, remove the batteries to prevent damage to the unit or injury from possible battery leakage
- Do not recharge batteries not intended to be recharged. Always follow the manufacturers directions
- Please only use alkaline batteries

Wireless range

If using as part of an extended system the range of these parts is a minimum of 1 meter, up to a maximum of 25 meters.

System activity

Please note, when the red light is on the product is processing, so no operation will work (for example, you will not be able to enter your PIN)

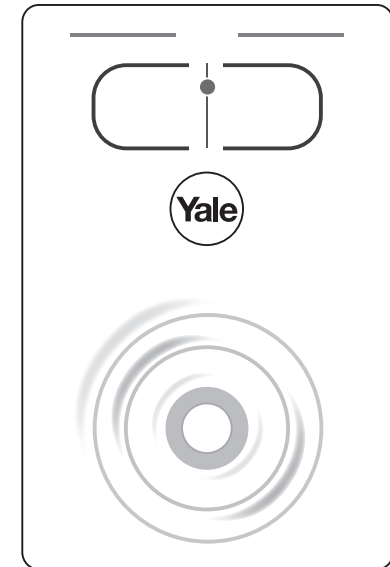

WEEE

Note: Waste electrical products should not be disposed of with household waste. Please recycle where facilities exist. Check with your local authority or retailer for recycling advice.



Yale
School Street, Willenhall,
West Midlands WV13 3PW
Tel: +44 (0) 1902 364606
Fax: +44 (0) 1902 364692
email: info@yale.co.uk
www.yale.co.uk

E1 09/08

SAA8021 Wirefree mini siren

User Manual

Keep this manual safe for future reference

Product diagram

Front

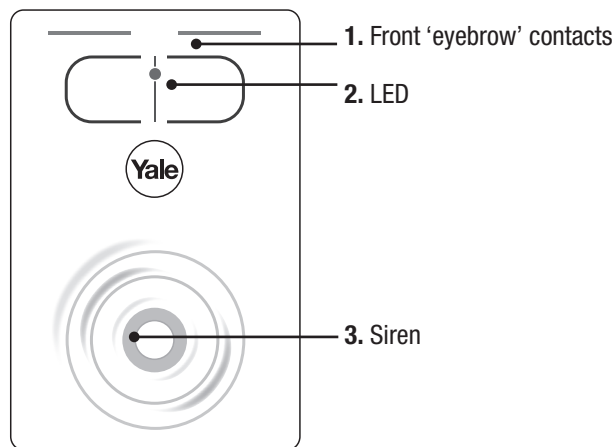

Back

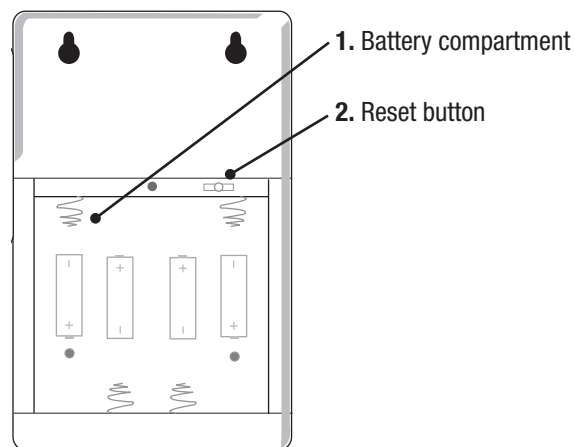

Battery installation

The battery compartment is located on the rear of the alarm unit. It can be accessed by removing the screw from the back of the unit and lifting the cover.

Insert 4 'AA' Alkaline size batteries (not included) as shown (diagram). When the last battery is inserted the centre red LED will flash 3 times. Replace the back cover and fix with screw.

NOTE: Please wait 30 seconds before inserting new batteries whenever you take old batteries out.

Installing the unit

The unit has been designed to be either free standing or wall mounted.

To wall mount;

1. Place the alarm in the desired location

Care and maintenance

To clean the unit, simply use a soft, slightly damp with water, cloth and wipe dry immediately.

Caution: Never use chemicals to clean the unit as this may cause damage to the plastic and result in the alarm not functioning.

Pairing the siren with another unit from the range

The standalone alarm range has been designed specifically to operate as single units or be paired together to work as kits.

Up to 3 of the master units – those that have sensors as well as sirens – can be paired together. The number of slave units – those that do not have sensors – that will work together is limitless. **This siren alarm is a slave unit.**

Each master unit has a unique radio code, which can be sent to any other unit in order to make them work together.

The procedure for doing this is as follows:

1. Starting with any master unit which you want to be the main teacher unit for the system
2. Enter your PIN code and then press the Yale button afterward.
3. The LED will flash in the sequence green, orange, red
4. The unit is now in 'sending' mode for the next 2 minutes. The green and orange LED will flash every second
5. Hold the rear metal contact points of the main unit against the 'eyebrow' contact points of the learner unit to which you are pairing
6. To confirm the units are paired, the learner unit will have Red LED on constantly (indicates units in contact) and will beep once afterward. Only release after you hear this beep.
7. Repeat this contact for all other learner units you want to pair with the teacher unit
8. After the 2 minutes 'sending mode' the main unit will return to disarmed mode. The red LED will flash 3 times to confirm.
9. If you wish to exit the learning mode within the 2 minute duration, press CLR button twice on the teacher unit to exit.

