

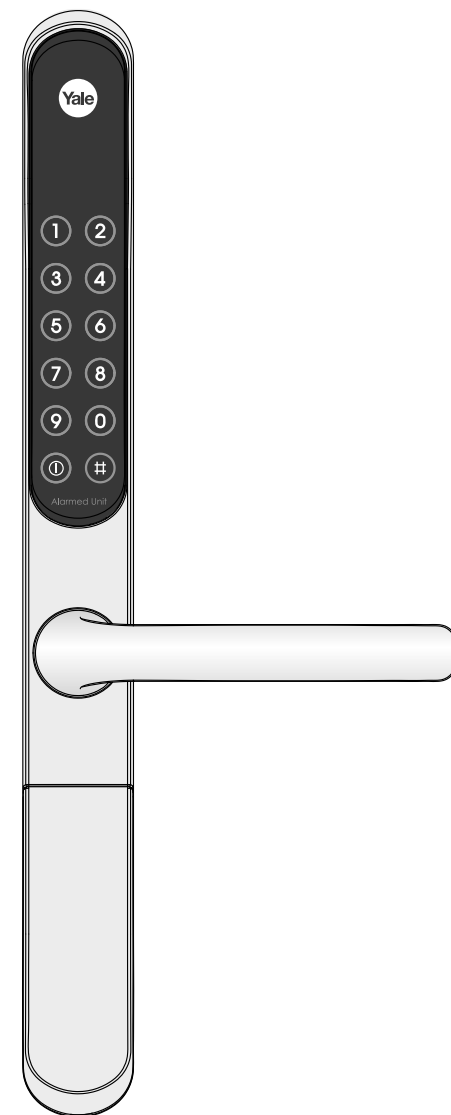

User Guide



INTRODUCTION

Thank you for choosing a Yale Keyfree product.

The new Yale Keyfree digital door lock uses the latest technology to make life so much easier.

This user manual enables you to operate the product safely and to its full potential.

Be sure to read this completely before using the Yale Keyfree product.



Keyfree Helpline (9am - 5pm)

0845 223 2128

Outside Office Hours Keyfree Helpline (5pm – 9am)

0800 590 925

**Only use incase of lock out or serious emergency
as you may be charged**

CONTENTS

Introduction

Safety Precautions	4
Product Features	5
Quick Guide	6

Directions

Components Overview	10
Identification	11
How to Use	12
Registration	
Opening Door	
Locking Door	
Settings	18
General Relock time	
Remote Relock time	
Silent mode	
Passage Mode	
Safety Feature	22
Child Safety Alarm	
Handle Alarm	
Intrusion Alarm	
3-minute Lock Feature	
Open Door with Fake PIN code	

Extra Features

Emergency Power	26
Emergency Power Supply for	
Discharged Batteries	
Product Specification / Contact Detail	27
Warranty	28

Safety Precautions

Please read this carefully

When you leave your home be sure to lift up the handle in the given time so the door is fully secure.

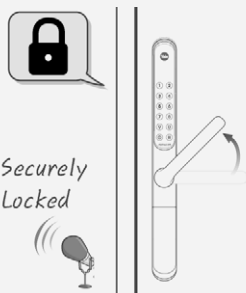

Be careful not to let any unauthorized users discover your PIN code.

Please keep your PIN code safe.

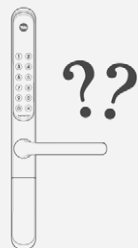

To maintain the high quality finish, clean regularly with a soft damp cloth taking care not to scratch the finish. Do not use any chemicals when cleaning as this may affect your warranty.

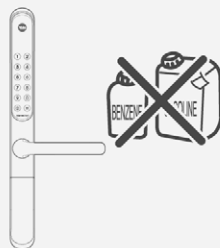

“Securely locking your door”

Press button & lift inner handle until “Lock closed, securely locked” can be heard. Red LED will show.

If the inner handle is not lifted to securely lock your door, the door is held on the latch only.

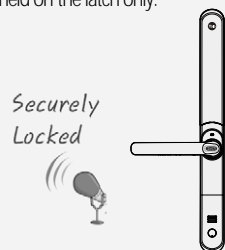

Please ensure the button is fully depressed when opening or locking your door from the inside.

If the button does not pop up when you release the lever, please slightly lift up the inside lever to make the button pop up for the best security.

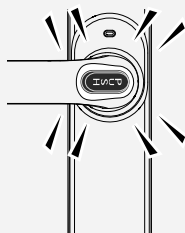

For total peace of mind, please store your back up key in a safe & convenient place after the door installation is complete.

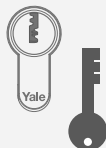

Caution Make sure to follow the above instructions to avoid any injuries or damage to the product .

Product Features

1 Alarmed Door Lock

Yale Keyfree door lock has a built in damage alarm. If the keypad area is damaged an 80dB alarm will sound.

2 Electronic PIN Code System

You can open the door conveniently with PIN code. Yale Keyfree door lock gives you the freedom and convenience of key-free.

3 Remote control System(Optional)

Use a Remote control to unlock your door “remotely”

4 Voice guide system

Voice guide talks you through features of Keyfree.

5 Emergency power back up

9V battery source is available if your batteries run out.

6 Fake Pin code

To prevent the Pin code being exposed. Yale Keyfree allows you to enter decoy numbers before or after entering your PIN code

7 Basic Security Locking

The handle automatically disengages on the outside once you have entered your home, preventing anyone from following in behind you.

8 Emergency escape internal handle with additional safety & security features

Integral push button design offering an immediate emergency exit at all times.

Quick Guide

1 Registering Your PIN Code

Family code is the code that you and your family remembers as your PIN.

The visitor code can be given to guests or work people. Once guests or work people have left you can change the visitor code without you or your family learning a new one.

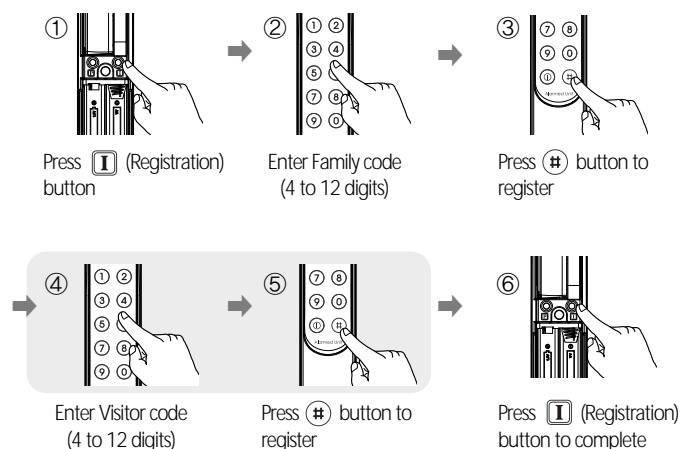

※ If you want to use just one PIN Code for family, then skip the ④~⑤th steps and press Registration button.

2 Registering Your Remote Controls (Optional)

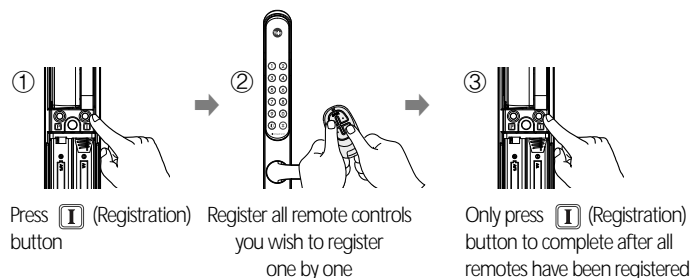
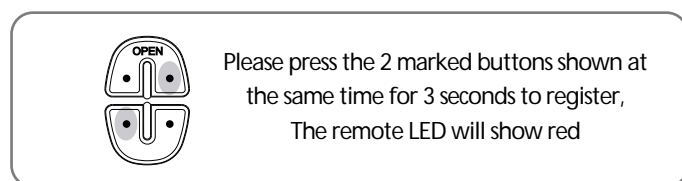

3 Securely Locking Your Door

- Inside : Press push button & lift the handle.
This can be done anytime and will always fully secure your door.
- Outside : Close the door and lift up the handle within the set connection time
Once the lever disengages you must enter your PIN or press remote and lift up the lever within the connection time to securely lock your door.

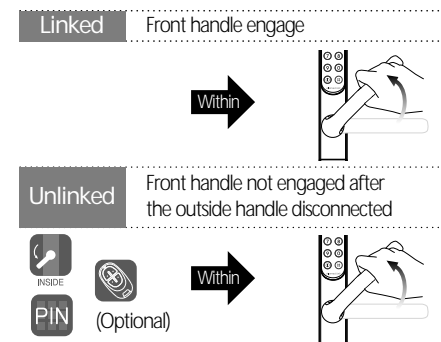

⚠ If the time expires you need to re-engage the handle to securely lock your door. You can re-engage by pressing the remote, pressing the inner lever down or entering your pin.

- ※ **Exception** : In the Passage mode, the handle is operable all the time.
- ※ The automatic disconnection time can be varied by user setting. Refer to section "settings".

⚠ **IMPORTANT** Your door is only securely locked from the inside when the inside lever is lifted up & the voice instruction "lock closed, securely locked" is heard & red LED shows.

4 Opening Your Door

• PIN Code

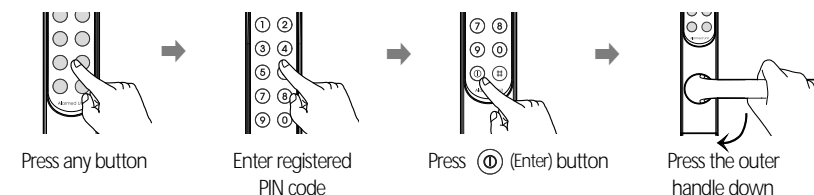

• Remote Control (Optional)

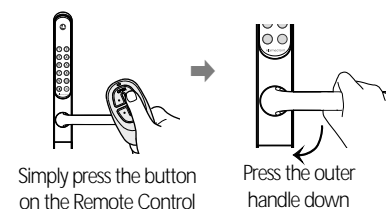

Quick Guide

5 Setting Menu

» General Relock time Setting

This is how quickly the outside handle will disengage once you have entered your home. This is variable between 7- 15 seconds.



» Remote Relock time Setting

This is how long the handle will stay engaged once you have pressed the remote.

You can have upto 90 seconds to allow you enough time to get out of your car & walk up your driveway.



» Silent mode Setting



» Passage Mode Setting

Passage mode allows you to go in and out of your home freely without the door locking behind you.

This is an ideal option for putting the bins out.



» Child Safety Mode Setting

This sounds an audible alarm if young children are trying to get out of the door without your knowledge.



» Handle alarm Setting

Allows you to alarm the inside lever handle when you leave your home. Simply enter your PIN hold the # for 5seconds & the inside lever if depressed will sound an audible sound.

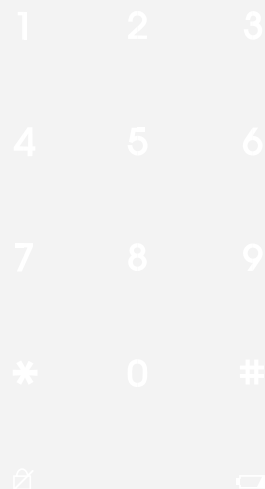

Directions

Components Overview	10
Identification	11
How to Use	12
Registration	
Opening Door	
Locking Door	
Settings	18
General Relock time	
Remote Relock time	
Silent mode	
Passage Mode	
Safety Feature	22
Child Safety Alarm	
Handle Alarm	
Intrusion Alarm	
3-minute Lock Feature	
Open Door with Fake PIN code	

Components Overview

Basic Contents

The contents of this product may be subject to change without notice for performance or quality improvement.

» Basic Contents

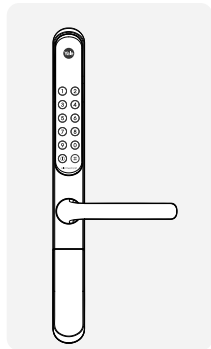

Front (Front Body)

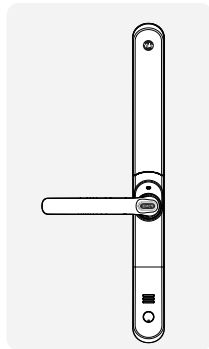

Back (Main Body)

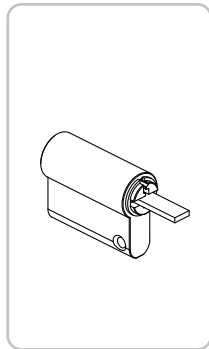

Cylinder

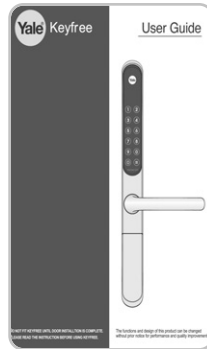

User Guide

» Optional Accessory

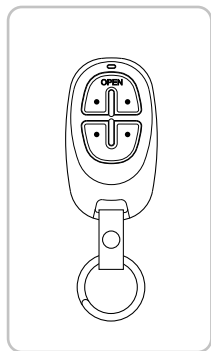

Remote control
(Optional)

Identification

Front (Front Body, install on the outside of the door)

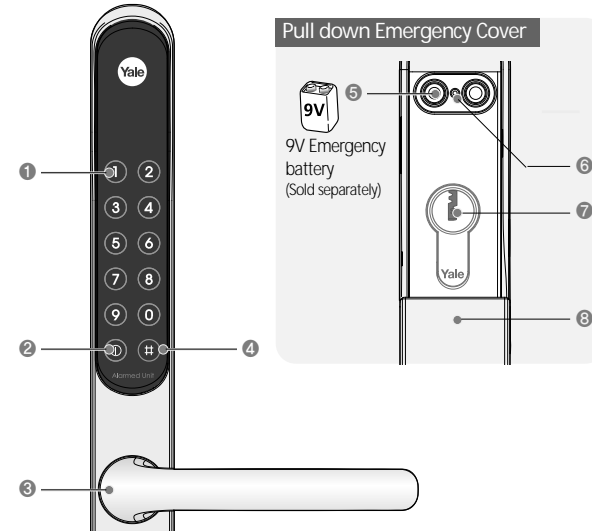

1	Keypad (10-Key)
2	Enter button
3	Lever Handle
4	# button
5	Emergency Power Supply Terminal
6	Reset button
7	Keyhole
8	Emergency Cover

Back (Back Body, install on the inside of the door)

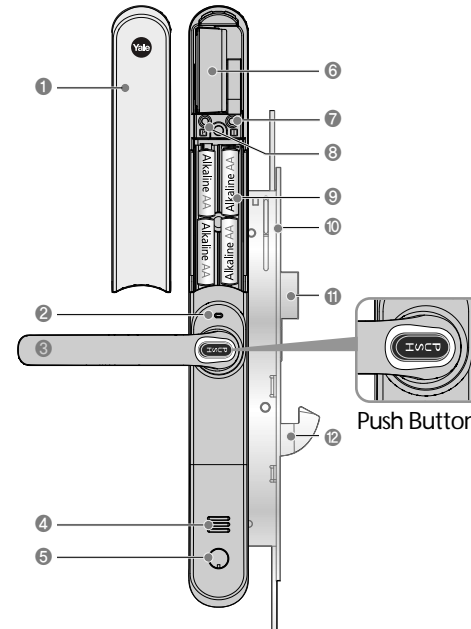













1	Battery Cover
2	LED Indicator
3	Lever Handle
4	Speaker Hole
5	Screw Hole
6	Slot for Remote control module (Optional)
7	I Registration button
8	Passage Mode/Child Mode
9	1.5V AA Alkaline Batteries
10	Lock case
11	Latch Bolt
12	Dead Bolt to securely lock

How to Use

Registration

» To Register PIN codes

Step	Icon	Description
1 Press  (Registration) button		Open the battery cover in the back body and press  (Registration) button once.
2 Enter the Family PIN code		Enter the Family PIN code you wish to register. (4 to 12 digits)
3 Press  button		Press the [#] button
4 Enter the Visitor PIN code		Enter the Visitor PIN code you wish to register. (4 to 12 digits)
5 Press  button		Press the [#] button
6 Press  (Registration) button		Press the  (Registration) button in the back body again to complete the PIN code registration.



Note

- Yale Keyfree supports dual PIN code. The first PIN code is called 'Family Code' and the second one is called 'Visitor Code'.
- This feature allows you to keep the combination number which is familiar and easy to remember for your family members from disclosure to other visitors.
- Step 4 and 5 are optional registration steps for the visitor code.













Caution

- Make sure to leave the door open when registering your PIN or Remote control because you may accidentally lock the door while trying to register or change a credential repeat above the first time.
- The previously registered PIN / remove control will automatically be deleted when a new credential is registered.
- It is recommended to change your security code on a regular basis.

How to Use

» To Register Remote controls (Optional)

Step	Icon	Description
1 Press  (Registration) button		Open the battery cover in the back body and press  (Registration) button once.
2 Register remotes in front of keypad		Press one of upper button and one lower button at the same time for 3 seconds to register. The remote will show red.
3 Verify the registration		Check the key pad lights go out & audible feedback of registration.
4 Register additional Remote controls		Press one of upper button and one lower button at the same time for 3 seconds to register. The remote will show red.
5 Verify the registration		Check the key pad lights go out & audible feedback of registration. If you want to register more Remote controls, please repeat step 4 & 5
6 Press  (Registration) button to complete		Press the  (Registration) button in the back body again to complete the Remote controls registration.

Check if the door opens!



Make sure to check if the door opens properly with the registered credentials after the registration is completed.



Note

If you loose a Remote contro please re-register the remaining remotes as above. This will remove access for the lost remove control.

How to Use

Opening door

» Inside

Step	Icon	Description
Press 'PUSH' button		Press the release button in and,
Opening the door		Press the inside handle down to open.

» Outside (After the outside handle **Engaged**)





Step	Icon	Description
Opening the door		Press the outside handle down to open the door during the general relock time.



Note



- The duration that the handle remains active lasts for 7 seconds in case of PIN code. (for 10 seconds in case of Remote control) Factory setting
- The term of engagement can be varied by user's menu setting. (see Setting-General Relock Time Setting)
- The mechanical key can be used for the battery ran out or in case of any electronic failure.

How to Use

» Outside (After the outside handle **Disengaged**)

Step	Icon	Description	With PIN code
1 Press any button		Press any button	
2 Enter PIN code		Enter the registered PIN code in the keypad.	
3 Press Enter button		Press Ⓢ button to confirm.	
4 Open the door		Press the outside handle down to open the door.	



Step	Icon	Description	With Remote (Optional)
Press 'OPEN' button		Press 'OPEN' button on the Remote Control.	
Open the door		Press the outer handle down to open the door.	

Step	Icon	Description	With KEY
1 Insert and turn the key		Insert and turn the key 90 degree in clockwise or anti - clockwise.	
2 Opening the door		Press the outer handle down to open the door.	
3 Taking the key out		Take the key out after opening the door.	

How to Use

Locking door

» Inside

Step	Icon	Description
Press 'PUSH' button		Press the release button in and,
Secure locking		Lift the handle to lock When securely locked voice instruction will say "Lock closed, securely locked"
Indicator Checking		Check the indicator colour flashing red. You are now fully locked.

» Outside (During the outside handle **Engaged**)

Step	Icon	Description
Secure locking		Lift outer handle up.

Note





- The duration that the handle remains active lasts for 7 seconds in case of PIN code.
(for 10 seconds in case of Remote control) Factory setting
- The term of engagement can be varied by user's menu setting. (see Setting-General Relock Time Setting on page 18)



Caution



- When leaving your home, make sure to lift up the handle.

How to Use

» Outside (After the outside handle **Disengaged**)

Step	Icon	Description	With PIN code
1 Press any button		Press any button	
2 Enter PIN code		Enter the registered PIN code in the keypad.	
3 Press Enter button		Press ① button to confirm.	
4 Secure locking		Lift outer handle up.	













Step	Icon	Description	With Remote (Optional)
Press 'OPEN' button		Press 'OPEN' button on the Remote Control.	
Secure locking		Lift outer handle up.	

Step	Icon	Description	With KEY
Insert and turn the key		Insert and turn the key 90 degree.	
Secure locking		Lift outer handle up.	

Settings

General Relock time

» General Relock time Setting

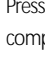
Step	Icon	Description
1 Press  (Registration) button		Open the battery cover in the back body and press  (Registration) button once.
2 Press  button		Press the  button to enter the menu mode.
3 Press [1] button		Press the [1] button to select general relock time.
4 Press  button		Press the  button to enter the general relock time setting mode.
5 Input General Relock time		Enter time from 7 to 15 seconds.
6 Press  (Registration) button		Press the  button in the back body again to complete the setting.













Note

- The default general relock time is set at 7 seconds.
- The general relock time is how long it takes for the outside handle to disengage after verification by PIN code.

Settings

Remote Relock time

» Remote Relock time Setting

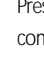
Step	Icon	Description
1 Press  (Registration) button		Open the battery cover in the back body and press  (Registration) button once.
2 Press  button		Press the  button to enter the menu mode.
3 Press [2] button		Press the [2] button to select general relock time.
4 Press  button		Press the  button to enter the general relock time setting mode.
5 Input General Relock time		Enter time from 10 to 90 seconds.
6 Press  (Registration) button		Press the  button in the back body again to complete the setting.











Note

- The default remote relock time is set at 10 seconds.
- The remote relock time is the handle disconnection time after verification by Remote control.

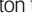
Settings

Silent mode

» Silent mode setting

Step	Icon	Description
1 Press  (Registration) button		Open the battery cover in the back body and press  (Registration) button once.
2 Press  button		Press the  button to enter the menu mode.
3 Press [3] button		Press the [3] button to select the Silent mode.
4 Press  button		Press the  button to enter the Silent mode setting.
5 Set the Silent mode		Press the [1] button to enable the Silent mode
		Press the [2] button to disable the Silent mode



Note

- When the silent mode is set, the door lock will be mute for any operation, except for locking confirmation sound and sounding the ALARM or warning of low battery.

Settings

Passage Mode

» Passage Mode setting

Step	Icon	Description
Press the passage mode button		Open the battery cover then press the passage mode button to activate the passage mode.
Indicator Checking	 GREEN	Check the indicator color in green, then replace the battery cover.

Note

The passage mode enables you to open your door at anytime and from any side. You can easily end this mode with lifting up the handle from any side. The flashing green LED indicates when the handle is in passage mode.

Caution

Please make sure to lock securely after using the passage mode.

Safety Feature

Child safety Alarm

Step	Icon	Description
Press and hold the passage mode button for 5 seconds.		Open the battery cover then press and hold the passage mode button for 5 seconds to activate the child safety mode. Replace the battery cover.





Note

In the child safety mode, depressing inside handle will sound the alarm for 10 seconds to notify the door is open to the parents inside. The alarm can be disarmed by using remote if it is not to be sounded for the full 10 seconds.

Handle Alarm

» Handle alarm Setting - PIN code

Step	Icon	Description
1 Press any button		Press any button.
2 Enter PIN code		Enter the registered PIN code in the keypad.
3 Press and hold the # for 5 Sec.		Press the [#] button for 5 seconds. (The beeping sound sets off for 3 times.)



Note

- When the handle alarm set, any operation of the handle from inside will sound the alarm for 3 minutes.
- Input in your PIN or by pressing your remote control will disable the handle alarm setting.

Safety Feature

Intrusion Alarm

Damage Alarm : If the circuit board of outer handle is damaged the alarm will sound.

Break-in Alarm : When the front handle is separated from the door the alarm will sound.

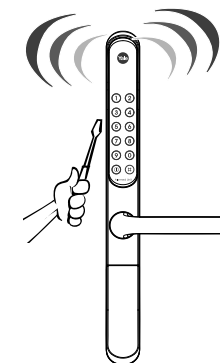

Release Alarm

- Method **1** Enter the registered PIN code.
 Method **2** Enter the registered Remote control.
 Method **3** Press the interior **①** or **②** button for 5 seconds.



Note

- Please activate the handle alarm only when everyone has left your property.

Safety Feature

3-minute Lock Feature

During the 3-minute Lock mode, buttons on the outer handle will not work.

» 3-minute Lock Mode Display

- If a wrong PIN code entered for 5 consecutive times, 3-minute Lock mode is activated and nothing will work for 3 minutes.

Note : You can try after 3 minutes.

To Release 3-minute Lock

Method ① Press any button inside of battery cover.

Method ② Depress inside lever handle.

Method ③ Press Remote control button.

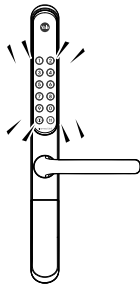

Opening Door with fake PIN code

This is an extra security measure to prevent your PIN code being accidentally exposed.
It is only available for your family code PIN number and not for use with the visitor code.

» To Open Door with fake PIN code

Step	Icon	Description
① Press any button		Press any button
② Enter the fake numbers and a PIN code		Method ① Enter the fake numbers* → PIN code Method ② Enter the PIN code → fake numbers* <small>*any that you choose do not have to be the same.</small>
③ Press Enter button		Press ➡ button to activate the outer handle and open the door.

Note

- 3-minute Lock mode won't affect any alarm and is sustained even after the product is rebooted.
- Once 3-minute Lock mode is on, the fake PIN code mode won't work until the next normal verification (PIN code, Remote control and open door from inside). In this case, please open a door with your regular PIN code only.

Extra Features

Emergency Power	26
Emergency Power Supply for Discharged Batteries	
Product Specification / Contact Detail	27
Warranty	28







Emergency Power

Emergency Power Supply for Discharged Batteries

You can open a door by contacting the 9V battery

» To Supply Emergency Power

Step	Icon	Description
1 Contact the 9V battery		Open the emergency cover. Keep contacting the 9V battery onto the emergency power supply terminal.
2 Press any button		Press any button
3 Enter PIN code		Enter the registered PIN code in the keypad.
4 Press Enter button		Press  button to activate the outer handle.

» To Replace Battery

1 Expiry Period

The product uses four 1.5V(LR6) alkaline AA batteries.
We estimate the key will last 1 year if used 10 times a day.
(Users are advised to use authentic alkaline batteries.)

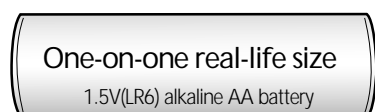

2 Low Battery Alarm

You must replace all 4 batteries for the following cases:

- * The Low Battery LED on the back body flickers red.
- * The voice guide sounds ("Low Battery")

RISK OF EXPLOSION IF BATTERY IS REPLACED BY AN INCORRECT TYPE. DISPOSE OF USED BATTERIES ACCORDING TO THE NATIONAL CODE OR RECYCLING PROGRAM

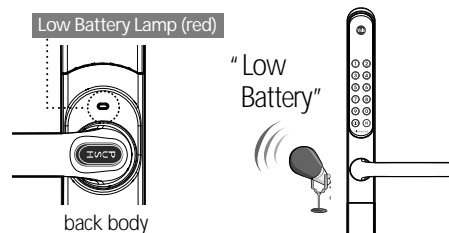

Note

- The battery life varies according to ambient temperature, humidity, the frequency of use, and the quality of the battery.
- Do not use rechargeable batteries. Only alkaline batteries are recommended.

Specifications

Specifications

Parts	Specifications	Remarks
Front (Front Body)	35mm(W) × 355mm(H) × 22mm(D) Zinc die-casting	Operating temperature : -15~55°C (5~131° F)
Back (Main Body)	35mm(W) × 355mm(H) × 40mm(D) Zinc die-casting	
Lever	Zinc die-casting	
Battery	4EA 1.5V AA alkaline batteries (Operating voltage: 4.5 ~ 6 V)	Last up to 1 year (when lock is used 10 times a day)

- ※ Battery life may vary depending on temperature, moisture levels, frequency of use and the quality of the batteries.
- ※ Please make sure that all parts are included when purchasing the product.
- ※ Optional products may not be available.

Contact Details

www.yalekeyfree.co.uk

Keyfree Helpline (9am – 5pm)

0845 223 2128

Outside Office Hours Keyfree Helpline (5pm – 9am)

0800 590 925

Only use incase of lock out or serious emergency as you may be charged



WEEE Note:
Waste electrical products should not be disposed of with household waste.
Please recycle where facilities exist.
Check your local authority or retailer for recycling advice.



Yale®

Product Warranty

Manufacturer's Warranty Period

Keyfree is covered by a 2 year Warranty that begins on the day of purchase by the original end user.

Proof of purchase date **MUST** be provided to the manufacturer at time of Warranty claim.

Warranty covers

The Warranty offered on the Yale Keyfree digital door lock includes finish and mechanical operation where applicable.

Finish: This 2 year warranty covers rust, corrosion, flaking, tarnishing and permanent streaking of the product finish.

The warranty does not cover scratches, normal wear through usage and damage caused by negligent damage or by cleaning the product with cleaning detergents. The warranty does not cover damage caused by impacts or accidents.

Mechanical: This Warranty covers the mechanical operation of door handle and against defects in materials, workmanship and operation.

The warranty does not apply to products that have been installed incorrectly, abused, misused or altered by the end user or a third party. The warranty does not cover damage caused by impacts or accidents.

Care Instructions

The surface of the product should be cleaned with a soft damp cloth taking care not to scratch the surface finish. Under no circumstances should cleaning detergents be used to clean the product as this will invalidate the finish warranty.

If there is a problem what will be done?

Yale will examine the product and decide if it is covered under the Warranty. If it is determined that the product issue has been caused through a fault in manufacturing or material finish then the product will either be replaced or repaired free of charge on behalf of the end user. This decision is at Yale's discretion.

Items excluded from Warranty:

- Batteries
- Screws
- Remote control (Optional) Antenna



Any false call outs regarding the warranty will be chargeable and not responsibility of Yale.



NOTES

NOTES
