



Window Lock

- Suitable for sliding sash windows



USE ON
TIMBER
WINDOWS

WHITE
FINISH

SUITABLE REPLACEMENT FOR CHUBB V-8K114-WE

FOR MORE INFORMATION SEE BACK OF PACK

Features

- Prevents intruders from opening window by releasing catch

Tools required

- Drill
- Drill 9mm (3/8") bit
- Hammer
- Flat bladed and pozidrive screwdrivers
- Bradawl
- Pencil
- Ruler

Fitting instructions

Prior to fitting familiarise yourself with it's simple action. If fitting onto a hardwood window it may be necessary to drill pilot holes for the fixing screws.

Caution: Before drilling or fitting screws check position of glass and seals.

1. Close window, mark intersecting centre lines on vertical and horizontal frames. Remove bolt from lock and position bolt hole where lines cross ensuring glass and seals are avoided when fixing. Mark and prepare end fixing hole, loosely fit a pozidrive woodscrew so lock will swing downwards.
2. With lock horizontal, open the cylinder and mark bolt hole centre. Swing lock body downwards, then carefully drill a 9mm (3/8") dia. Hole through inner and outer frame to suit bolt length when locked, ensure drill is level and straight. If additional ventilation position required open window maximum 100mm (4") and drill through bolt hole to same depth as before using hole in inner frame as guide.
3. Close window, position lock body horizontally and fit locking bolt. Mark remaining fixing hole, remove bolt then swing lock down and prepare hole. Return lock to horizontal, re-fit locking bolt and fix woodscrew. Remove and discard both woodscrews and re-fix using the one way screws supplied for extra security. Do not overtighten. Tap ferrule into ventilation hole, if drilled, and into main locking hole in outer frame. Ehwon lock not in use bolt can be stored in the additional hole in lock body.

NB Equivalent imperial sizes are approximate.

Do not use abrasive cleaners, solvents or polish. Only a moist soft cloth.

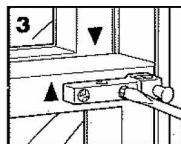
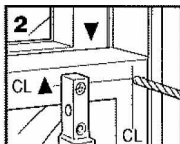
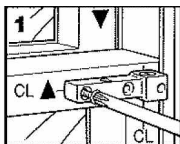

Yale

The world's favourite lock

www.yale.co.uk E-mail: locksinfo@yale.co.uk

V-8K114-WE



ISSUE 3