

FITTING INSTRUCTIONS V-8K102-WE

● Fitting instructions

Prior to fitting familiarise yourself with its simple action.

Tip: If fitting onto a hardwood window it may be necessary to drill holes for the fixing screws. **Caution:** Before fitting Screws check position of glass and seals.

1. Close window, position locking plate onto window 0.5mm (1/32") from the edge of the fixed frame. Mark prepare and loosely fix top screw. Mark bottom fixing hole, open window and swing locking plate aside, prepare hole. Close window and fit bottom screw ensuring locking plate is vertical. Secure top and bottom fixing screws (Fig 1)

Do not overtighten

2. Lock the body and the locking plate together and mark top fixing hole. Remove lock and prepare hole. Replace lock and loosely fit top fixing screw. If necessary use the wedge supplied to ensure lock body is tight to locking plate. (In exceptional circumstances wood may also have to be removed). Mark bottom fixing hole then unlock and open window, swing lock aside, prepare hole and fix screw.

Secure both screws as before. Check operation. Insert plastic cap to conceal screwheads. (Fig 2)

NB. Equivalent imperial sizes are approximate.

Do not use abrasive cleaners, solvents or polish. Only a moist cloth

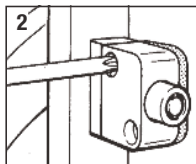
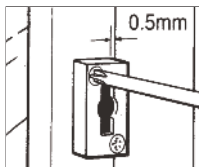

The world's favourite lock

www.yale.co.uk E-mail: locksinfo@yale.co.uk



2 Year Guarantee Statement

This product is guaranteed for consumers against faulty workmanship, materials and function for a period of 2 years from the date of purchase providing the full installation and maintenance instructions are followed. Please keep your proof of purchase safe, this must be submitted when making a claim under this guarantee.

Please note that it is a condition of this guarantee that your Yale product:

- Has been correctly installed and maintained in accordance with the Yale installation and maintenance instructions provided to you at the time of purchase.
- Has not been modified or damaged in any way.
- Has not been subjected to unauthorized repairs.

Yale are responsible under this guarantee for repairing the product or replacing the product as we deem necessary. If there is fault with the product, please contact Customer Services on 01902 364647, who will give you the name of an expert and confirm what you need to do to make a claim under this guarantee.

Please do not carry out any repairs without our authority or by using an unauthorised expert. Any repairs or other works carried out without our authorization or by using an unauthorized expert will not be covered under this guarantee.

This guarantee is non transferrable and applies to products purchased in the United Kingdom only. This guarantee does not apply to normal wear and tear. This does not affect your statutory rights. A full copy of this guarantee is available upon request by writing to Yale UK, School Street, Willenhall, West Midlands. WV13 3PW or by visiting our website www.yale.co.uk.