



P-YSMDC Surface Mounted Door Closer Fitting Instructions

Tools Required



Cross Head
Screwdriver

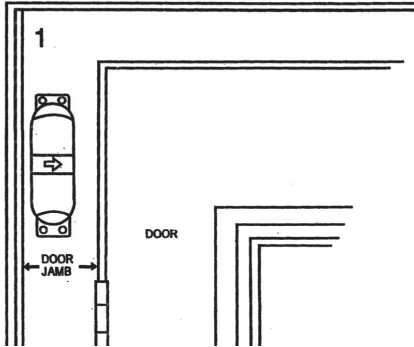

1. Fix the main body of the door closer on the surface of the door jamb or door frame. The jamb or frame must be flush with the surface of the door. Fix using the 4 screws supplied and make sure the main body is square to the door and the arrow points in the direction of the door lockset.

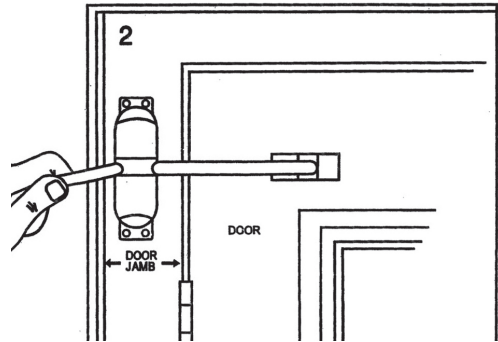

2. Screw the plain steel rod into the centre ring and with the arrow facing you, turn the centre ring away from the door. At the same time screw into position the closer arm into the hole closest to the door.

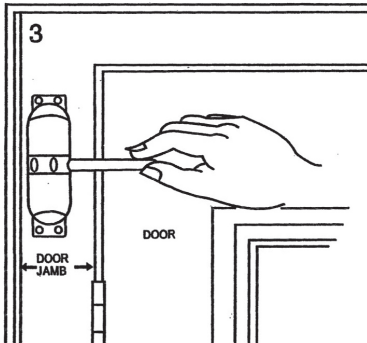

3. The tension regulates the closing speed of the door. To increase the closing speed, increase the tension by repeating the operation as stated in figure 2. For proper adjustment, increase the tension one hole at a time

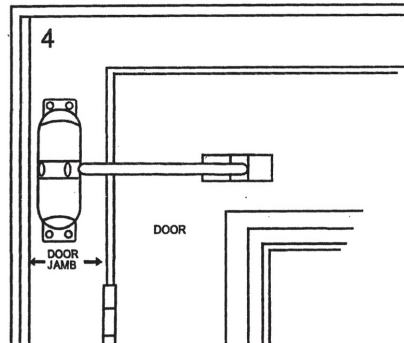

4. After the desired closing speed is obtained, position the plastic mat under the closer arm and fix to the door with the screw provided.



The world's favourite lock since 1843

School Street, Willenhall, West Midlands WV13 3PW

www.yale.co.uk Tel: +44 (0) 1902 364647 E-mail: info@yale.co.uk

Issue No: 01-2012