

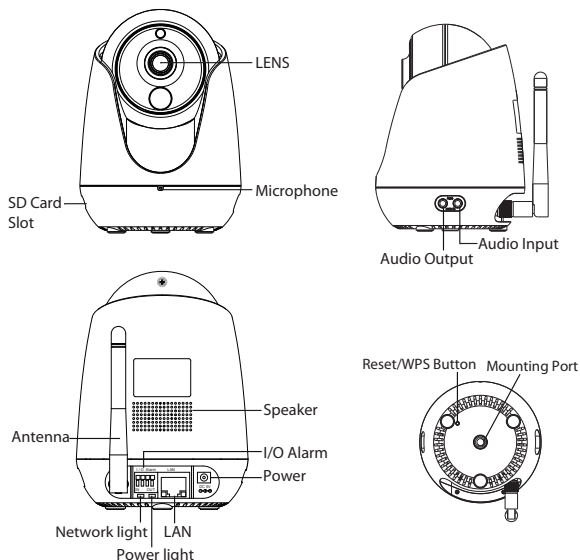

Home View Pan, Tilt, Zoom Camera (WIPC-303W)

Quick Start Guide



Inside the Box



Home View
Pan Tilt Zoom
Camera



AC Power
Adapter



Mounting Bracket



Ethernet Cable



Quick Installation
Guide



Wi-Fi Antenna

For more information on this product
and Yale Smart Living Range visit
www.yale.co.uk/smart-living
Consumer Support: info@yale.co.uk



The 2 year guarantee for this
product is active from the date
of purchase (A copy of this
guarantee is available on our
website).

Mounting Your Home View Camera

The Home View Camera can be free standing or fixed in place. To mount your Home View Camera, please follow the steps below.

1. Screw the mount on the wall with the two screws provided.
2. Loosen the thumb screws to adjust the mount to the desired position. Once the position is set, tighten the screws securely.

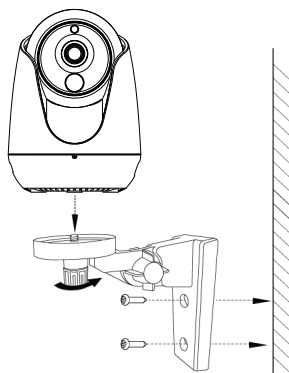

Network Light Status

Network Light	Description
Constant Light	Wired connection
Flashing every 0.2 seconds	Wireless Connection (default)
Flashing every 0.4 seconds	WPS is connecting
Slow Flash every 1.0 second	Wi-Fi connected

Information and illustrations are subject to change. Yale reserves the right to alter the specification and product design at any time without notice.

Due to a continuous programme of improvement, we reserve the right to discontinue support for older iOS and Android operating systems.

Hardware Connection

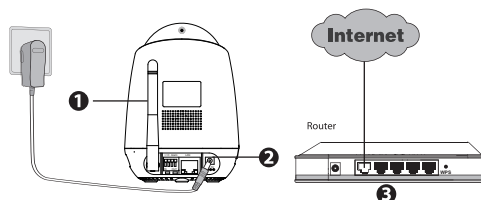

1. Fit Wi-Fi antenna to your Home View Pan, Tilt, Zoom Camera and position upright.
2. Connect the AC power adapter to the camera.
3. Ensure your wireless router is turned on and connected to the internet.

Before you continue, please note:

- Make sure your Smartphone is located near the camera.
- Do not use an ethernet cable to connect the camera if you want to use a wireless connection.
- Make sure your Smartphone is connected to your wireless router.

To View & Operate Via Smartphone

1. Go to the App Store or Google Play Store and search for the Yale Home View App.



2. Download and Install the App.
3. To add the IP Camera, open the App and tap the '+' button on the App and follow the setup wizard to add your camera.

Issue No. 1A



WEEE

Note: Waste electrical products and batteries should not be disposed of with household waste. Please recycle where facilities exist. Check with your local authority or retailer for recycling advice.