

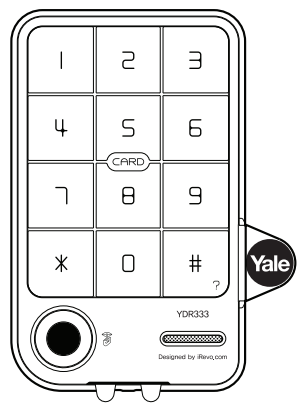

User Guide YDR333



※ The functions and design of this product can be changed without prior notice for quality improvement.

1 Safety Precacutions

- Do not attempt to disassemble the unit by yourself. That can cause an electronic shock and product damage.
- Do not spray water directly to the product or wipe it with chemical substances such as benzene, thinner, or alcohol when cleaning the product.
- Do not force with a tool.
- Be careful not to let any unauthorized users discover your PIN Code. Please keep your PIN Code safe.

Basic Contents

- Card Keys
- Screws
- Installation Template
- User Guide

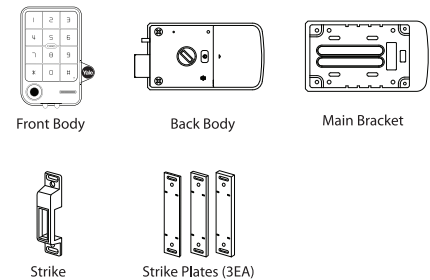

Specifications

Parts	Specifications	Remarks
Front Body	66,8(D) X 108(W) X 16(H)	Operating temperature: -15 ~ 55℃
Main Body	161 (D) X 92(W) X 36,5(H)	
Battery	4EA 1.5V AA alkaline batteries (Operating voltage: 4.5 ~ 6 V)	Last up to 1 year (10 times used a day)

⚠ The durability depends on the battery life and the frequency of use. The color of the product may change if it is under the direct light for a long time, and it is not a defect.

[Front Body]

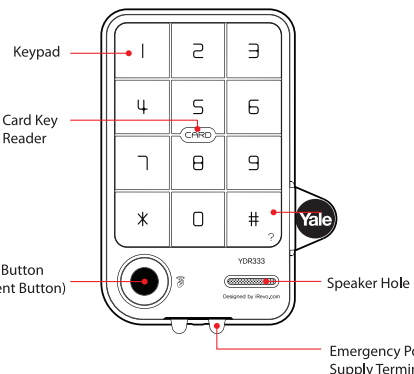

[Back Body]

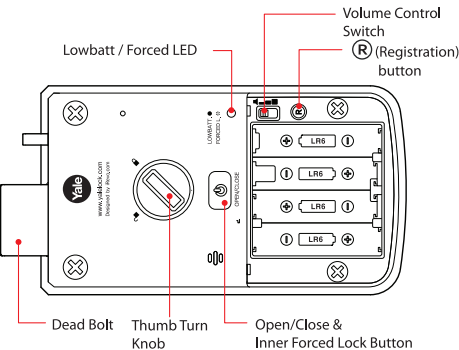

2 To Registering User PIN Code

Press (R) button (Registration) button → Enter User PIN Code (6 to 12 digits) → Press (R) button (Registration) button

3 To Registering Card Key

Press (R) button (Registration) button → Contact all the keys you wish to register on one by one → Press (R) button (Registration) button

- ⚠ - Keep the door open while you register Card Key to prevent yourself from accidentally getting locked out.
- The previously registered Card Key will automatically be deleted when the new Card Key is registered.
- Please use the only provided RF Cards in the package for security.

4 Open / Close Door from outside

Open Door with PIN Code

Touch with palm → Enter User PIN Code → Touch with palm or press * button to end

Opening the door quietly

Press Eye button → Enter User PIN Code → Touch with palm or press * button to end

Open Door with Card Key

Contact Card Key

Opening the door quietly (Outside)

Press Eye button → Contact Card Key

Locking the door

Locking the door: touch the keypad on the outside or press the eye button

- Locking the door with palm touch: sounds motion alarm/voice
- Locking the door with eye button: no motion alarm/voice

Opening Door with fake PIN Code

This is an security measure to prevent your PIN Code being accidentally exposed. It is only available for your family code PIN number and not use with the visitor code.

Method 1 Touch with palm → Press any button → Press PIN Code → Touch with palm
Method 2 Touch with palm → Press PIN Code → Press any button → Touch with palm
Method 3 Press Eye button → Press any button → Press PIN Code → Touch with palm
Method 4 Press Eye button → Press PIN Code → Press any button → Touch with palm

※ Methods 3 and 4 are fake PIN Code to open the door quietly.

5 Register one-time use PIN Code

If the host is not present, one-time use PIN Code can be set for visitor to use only once.

Press (R) button (Registration) button → Enter # button → Enter 0,7 button → Press (R) button (Registration) button

→ Enter One-time use PIN Code → Press (R) button (Registration) button

6 How to delete One-time use PIN Code

It is deleted automatically if you open the door with the one-time use PIN Code when it is locked.

7 Open / Close Door from inside

If you touch the (O) open/close button inside, then you can open and close the door.

Opening the door quietly (Inside)

You can turn the thumb turn knob 90 degrees to open or close the door.

- ⚠ If you set the thumb turn knob at "disuse" in 8 below, then the alarm will sound upon turning the thumb turn knob.

8 Thumb Turn Knob use/disuse (default: use)

Press (R) button (Registration) button → Enter # button → Enter 0,8 button → Press (R) button (Registration) button

※ It alternates between "use" and "disuse"

- ⚠ If you use thumb turn knob to open the door when it's at "disuse," then the alarm will sound.

9 Outside forced lock setting

If you use this setting when there's no one inside, then the alarm will sound upon opening the door with thumb turn knob.

Outside Forced Lock Setting - User PIN Code

Touch with palm → Enter User PIN Code → Enter # for 3 seconds

Outside Forced Lock Setting - CARD

Contact the Card Key on [Card Key reader] for 3 seconds until you hear 3 beeps.

Release setting

Method 1 Enter User PIN Code

Method 2 Contact Card Key

- ⚠ If you set outside forced lock setting, then the alarm sounds automatically if the door opens the inside, so be careful to check that there's no one inside.

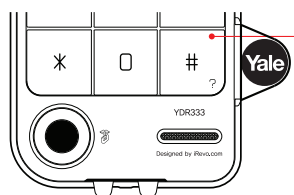

Enter the pass word and press for 3 seconds to set outside forced lock setting.

10 Inside forced lock

It is to prevent opening the door from outside with PIN Code or card key.

Inside forced lock setting

press (O) (open/close button) for 5 seconds with the door closed ("beeping" 4 times)

Checking the inside forced lock setting

press (O) (open/close button) inside, then voice or motion alarm sounds with the red light flashing on inside forced lock setting status.

- ⚠ After setting the inside forced lock, press open/close button inside to check if it is done right.

Removing the inside forced lock

Method 1 press (O) (open/close button) for 5 seconds.

Method 2 Used to thumb turn knob.

- ⚠ If you set the thumb turn knob at "disuse" in 8, then thumb turn knob cannot be used to remove the inside forced lock setting (alarm sounds).

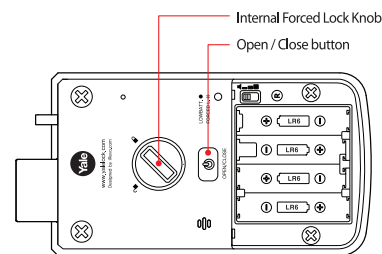

11 Automatic / Manual Lock Setting

To Set Auto Lock Setting

Auto Lock setting locks a door within 5 seconds after the door is closed.

Press (R) button (Registration) button → Enter # button → Enter 0,1 button → Press (R) button (Registration) button

- ⚠ Even after a door was locked by the Auto Lock function, please check again if the door was completely locked.

To Set Manual Lock Setting

If it is set at manual lock, then the door does not lock automatically even if you close the door.

Press (R) button (Registration) button → Enter # button → Enter 0,3 button → Press (R) button (Registration) button

※ If you want to lock the door at manual lock setting, then press open/close button, touch the keypad with the palm or press the eye button.

- ⚠ Be careful not to leave the door open at manual lock mode.

12 Volume Setting Feature

It enables you adjust the sound volume.

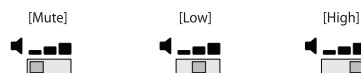

13 Alarm Feature

Break-in / Damage Alarm

Break-in : When someone tries to Break-in by opening a door when it is locked, the alarm will Sound.

Damage : When the front body was damaged due to forced separation or drilling, the alarm will Sound.

High Temperature Alarm

* When there's fire, it detects the temperature of the inside. It not only Sounds an alarm but also releases the lock status automatically.

* Even when the inside Forced Lock mode is set, the High Temperature Alarm releases the lock status automatically.

Release High Temperature Alarm

Method 1 Enter User PIN Code or Contact Card Key

Method 2 Press the interior (O) button for 5 seconds.

14 3-minute Lock Feature

If incorrect security codes or unregistered Card Keys are attempted 5 times in a row, it will lock out for about 3 minutes with the blinking LED.

To Release 3-minute Lock

Method 1 Press (O) button

Method 2 Press (R) button (Registration) button

15 Supplying emergency power

If you cannot open the door because of discharged batteries, then contact the 9V battery to the emergency power supply terminal and enter the pin code or touch the card key. Keep the contact of the 9V alkaline battery until unlocking door.

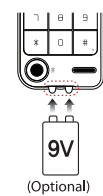

16 To Replace Battery

Expiry Period

The product uses four 4.5V Alkaline AA batteries. They may sustain 1 year if used 10 times a day. (Users are advised to use authentic alkaline batteries.)

Low Battery Alarm

You must replace all 4 batteries for the following cases:

- * The Low Battery Lamp on the Front Body lights on
- * The alarm melody will sound (a nursery rhyme starting with ting-a-ling melodies)

- ⚠ The battery life vary depending on temperature, moisture levels, Frequency of use and the quality of the batteries.