

Quick start-up guide

Welcome!

Thank you for buying a Yale safe.

Before operating your new Yale safe, please read the user manual and fitting guide to ensure maximum performance.

For any inquiries visit www.yalelock.com

Setting your user code

1 unlock door

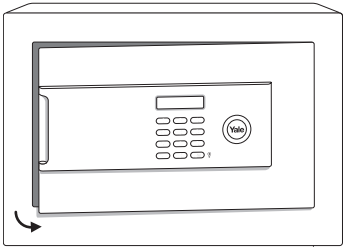

2 ENTER + 3

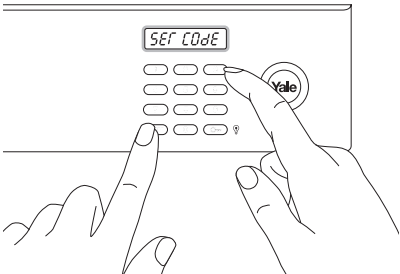

3 code →  → code → 

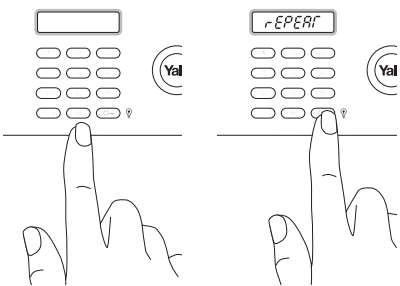

4

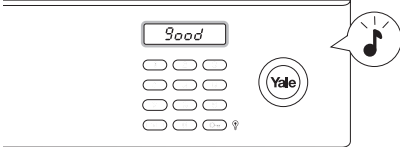

Please do not store the mechanical override keys inside the safe.

Opening the safe

1 press **ENTER**

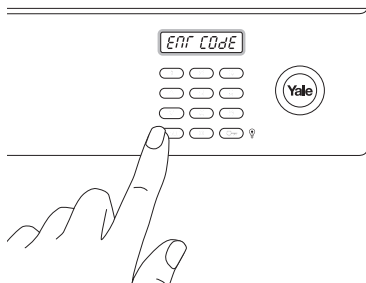

2 code → **ENTER**

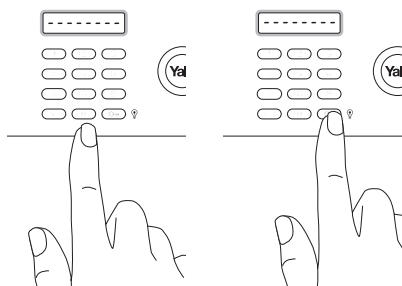

3

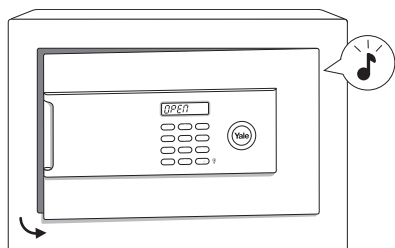

Closing the safe

1 close door

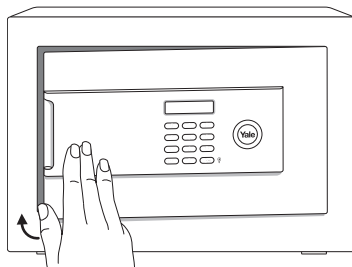

2 **ENTER** → **ENTER**

